

2019 Kit Graduate School Program Introduction

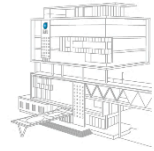

ABOUT kit



1. Vision and Specialization

Since the foundation in 1980 as a university specialized in engineering, kit has cultivated practical and creative engineering talents necessary for the development of national industry. To make a big push, kit has been committed to the growth of students, faculty members, regional communities, and national scientific technology through the advanced curriculum and education programs. Kit has been recognized for having infinite potential for growth, a high-quality practical education system, and a high postgraduate employment rate.

Therefore we are going to elevate our status as the most powerful national engineering university by developing scientific technology and multifunctional talents, leading the industry academy cooperative research based on challenging and creative spirits, and becoming a glocal (global+local) university with regional communities.

Future education should focus on nurturing creative talented individuals and contributing to the development of regional communities. To this end, universities have to make innovations in the fields of education, research, and cooperation of academy and business. Matching the changes in universities, kit changes the education system to develop sufficient experience based self-directed engineers, and strengthens the foundation for developing regional community and the nation by training multifunctional talents with right personality and leadership.

2. Location and Address

61 Daehak-ro, Gumi, Gyeongbuk, South Korea

90 mins from Seoul (Capital) to Gumi by express train, 3 hours by express bus

City of Gumi

- Population: 420,000
- Business Composition: Electronic products 84%, Machinery 4%, Plastics 4%, others 8%
- Exports: USD 34.4 Billion
- Industrial Area: 41km² (existing 24.4km², additional 16.6km²)
- Labor Pool: 100,025

Korea's largest national industrial complex

population of 420,000

- A total of **2,005** businesses moved in.
- Export : **5.7%** nationwide
- Trade surplus: **41%**
- Annual gross production of Gumi hits **48 trillion won.**

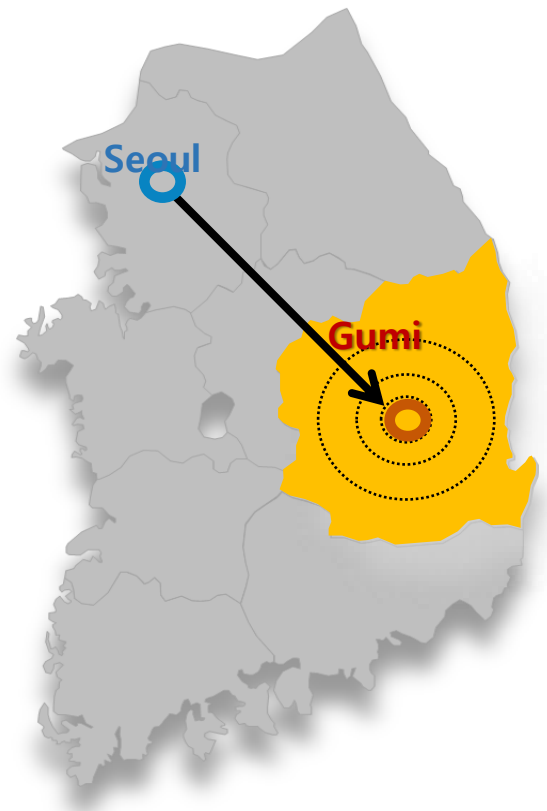
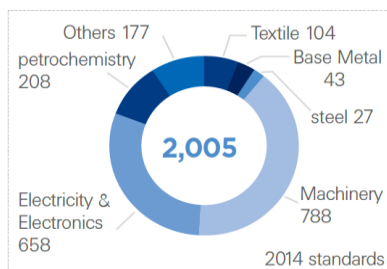

LG



Hanwha



CONTACT DETAILS & PROGRAMS WE OFFER

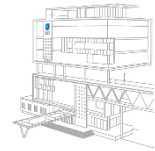

International Office Staffs

Eugene Park	Minah Kim	Soyeon Kim
Coordinator	Coordinator	Coordinator
		
eugene@kumoh.ac.kr eugenepark.kit@gmail.com	minah@kumoh.ac.kr	soyeon@kumoh.ac.kr
+82-54-478-7223	+82-54-478-7216	+82-54-478-7215
Graduate School Program GKS Program	Korean Language Program Undergraduate School Program	Int'l Student's Activity English Language Program Student Mobility Program

University webpage <http://eng.kumoh.ac.kr>

Facebook <https://www.facebook.com/kit.intl>

<https://facebook.com/groups/kit.intl>

Programs we offer

- √ [degree] Undergraduate School Program for International Students
- √ [degree] Graduate School Program for International Students
- √ [degree] Dual Degree Programs for Undergraduate and Graduate School
- √ [non-degree] Korean Language Program for International Students
- √ [non-degree] Student Exchange (Mobility) Programs for International Students

DEPARTMENT/MAJOR WE OFFER



Degree	Department	Doctoral /Integrated degree	Master's	Quota
Engineering	Mechanical Engineering	O	O	unlimited
Engineering	Mechanical System Engineering	O	O	unlimited
Engineering	Mechanical Design Engineering	O	O	unlimited
Engineering	Electronic Engineering	O	O	unlimited
Engineering	IT Convergence Engineering	O	O	unlimited
Engineering	Computer Engineering	O	O	unlimited
Engineering	Software Engineering	O	O	unlimited
Engineering	Architectural Engineering	O	O	unlimited
Engineering	Civil Engineering	O	O	unlimited
Engineering	Environmental Engineering	O	O	unlimited
Engineering	Industrial Engineering	O	O	unlimited
Engineering	Materials Science and Engineering	O	O	unlimited
Engineering	Polymer Science and Engineering	O	O	unlimited
Engineering	Materials Design Engineering	O	O	unlimited
Engineering	Energy and Chemical Engineering	O	O	unlimited
Engineering	Medical IT Convergence Engineering	O	O	unlimited
Engineering	Optical Engineering	n/a	O	unlimited
Natural Sciences	Mathematics	O	O	unlimited
Natural Sciences	Physics	O	n/a	unlimited
Natural Sciences	Applied Chemistry	O	O	unlimited
Business Administration	Business Administration	O	O	unlimited

*Only Ph.D will be conferred without a Master's degree after completing Integrated degree program.

Tip!) When you apply for Graduate School admission, please make sure to contact future supervisor professor you want to work for. Matching the Graduate School applicant and supervisor is very important for the Graduate School admission stage.

It is important to be fully prepared for your studies before entering kit, so please make sure to contact your future supervisor about any questions or concerns regarding your study plan or the study environment before application. You can access the contact information for all faculty members of kit through the kit English webpage(<http://eng.kumoh.ac.kr>).

2019 ACADEMIC CALENDAR & HOLIDAYS



Academic Calendar

Spring(1st) Semester

Course registration	Feb 12 to 15
Dormitory opening	March 2
Orientation	Mar 4
Semester begins	Mar 4
Course add & drop period	Mar 4 to 7
Spring festival	TBD
Final exam	June 17 to 21
End of spring semester	June 21
Dormitory move-out	June 21
Summer vacation	June 24 to Aug 31

Fall(2nd) Semester

Course registration	Aug 19 to Aug 22
Dormitory opening	Aug 30
Orientation	Sep 2
Semester begins	Sep 2
Course add & drop period	Sep 4 to 6
Final exam	Dec 16 to 20
End of fall semester	Dec 20
Dormitory move-out	Dec 20
Winter vacation	Dec 23 to Feb 28

Public Holidays

- New Year's day: Jan. 1st
- Lunar New Year's holidays: Dec. 31st, Jan. 1st, and Jan 2nd in lunar calendar. Most places are closed during this New Year's holidays. During this time many people come to visit their families hometown, all relatives gather to honor their ancestors with traditional rituals, and bow to their elders 「sebae」 .
- Independence Movement Day: March 1st, a day to commemorate the independence movement on March 1st against colonial Japanese rule.
- Buddha's Birthday: April 8th in lunar calendar. This holiday is held in honor of Buddha's birth, and colorful ceremonies are held in Buddhist temples.
- Children's day: May 5th. This is a day for children. People give children presents, or go to picnic with them.
- Memorial Day: June 6th. This holiday is held to remember the war dead. Memorial services are held throughout the country, and many people visit the National Cemetery in Seoul, bringing flowers and special food.
- Independence Day: August 15th. This holiday celebrates liberation from Japan after 35 years of colonial rule.
- Chuseok holidays: August 14th, 15th, and 16th in lunar calendar. This is one of the most important festivals like New Year's day in Korea. However, people do not 「sebae」 on Chusok unlike Lunar New Year's day.
- National Foundation Day: October 3rd. This day marks the founding of Korea by the founder, Tan-gun, in 2333 B.C.
- Hangul Day: The day for the excellence of honor of Hangul(Korea) and celebration of Hangul invention
- Christmas: December 25th. In general, Christians love to hold a grand celebration of Christmas.

Other Holidays

- Election Day: This is a public holiday to allow people to vote.
- Labor Day: May 1st. This is a holiday held only for those in the work force. Banks and most companies close for the day. However, public servants are expected to work, and teachers and students must go to school on this day.

SCHOOL FACILITIES



Dormitory (on-campus housing)

- Single room(very small number of vacancies), double room, quad room are available.
- International students can choose 5 days meal(per week) option, 7 days meal options or no meal option.
- In dormitory cafeteria, only Korean food will be served (lots of pork and spicy food, no halal food).
- Kitchen for international students is available.
- Students have to change dormitory room for every semester and every vacation (4 times a year).
- Students staying in dormitory must submit TB test result for one time a year.
- Each room, we have bed, desk, chair, closet
- dormitory fee (for 15 weeks, a semester)

Bldg.	Room type	Meal option	1 st semester, 2019 [KRW] (2019.03.02.~06.22.)		
			Maintenance cost	Meal fee	Total Cost
Pureum 2/ Shinpyeong	double	7days(lunch,dinner)	462,000	622,720	1,084,720
		5days(lunch,dinner)	462,000	503,670	965,670
		no meal	462,000	0	462,000
Pureum 3, 4	quad	7days (lunch,dinner)	385,000	622,720	1,007,720
		5days (lunch,dinner)	385,000	503,670	888,670
		no meal	385,000	0	385,000

Facilities



Accommodation (outside of campus)

- Near the campus, there are many real estate agencies which can help you to rent your own apartment.
- There are lots of studio apartments near the campus. (5 mins to campus by foot or bus)
- TV, air conditioner, cooking gas, refrigerator and washing machine are provided in most studio apartments.
- Housing contract has to be done by yourself individually.

Interfaith Prayer Room

- Inside of kit dormitory, we have interfaith prayer room.
It is available to all students.



Cafeteria

- There are three cafeterias on campus. One cafeteria is located inside the dormitory and is only for dormitory residents. The other two are available to everyone, and serve Korean, Chinese, and western style foods. Prices range from 2,000KRW to 4,500KRW per meal.

Café

- A Book café is centrally located on campus and offers hot and cold beverages and snacks at a reasonable price.

Bank

- There is a bank (Nonghyup Bank) located on campus. You can open your bank account, exchange currency and transfer currency domestically and overseas at this bank.

Convenience Store

- You can purchase daily supplies at one of several convenience stores on campus. Convenience stores are also located in several dormitories.

Sports facilities

- Gym, Tennis courts, Ping Pong, Soccer/Football stadium, Futsal stadium, Golf club are all located on campus. Use of some facilities, such as the golf club, require fees.



Others

- beauty(hair) shop
- bookstore
- photocopy room
- outdoor concert hall
- free medical center

ADMISSION PROCESS

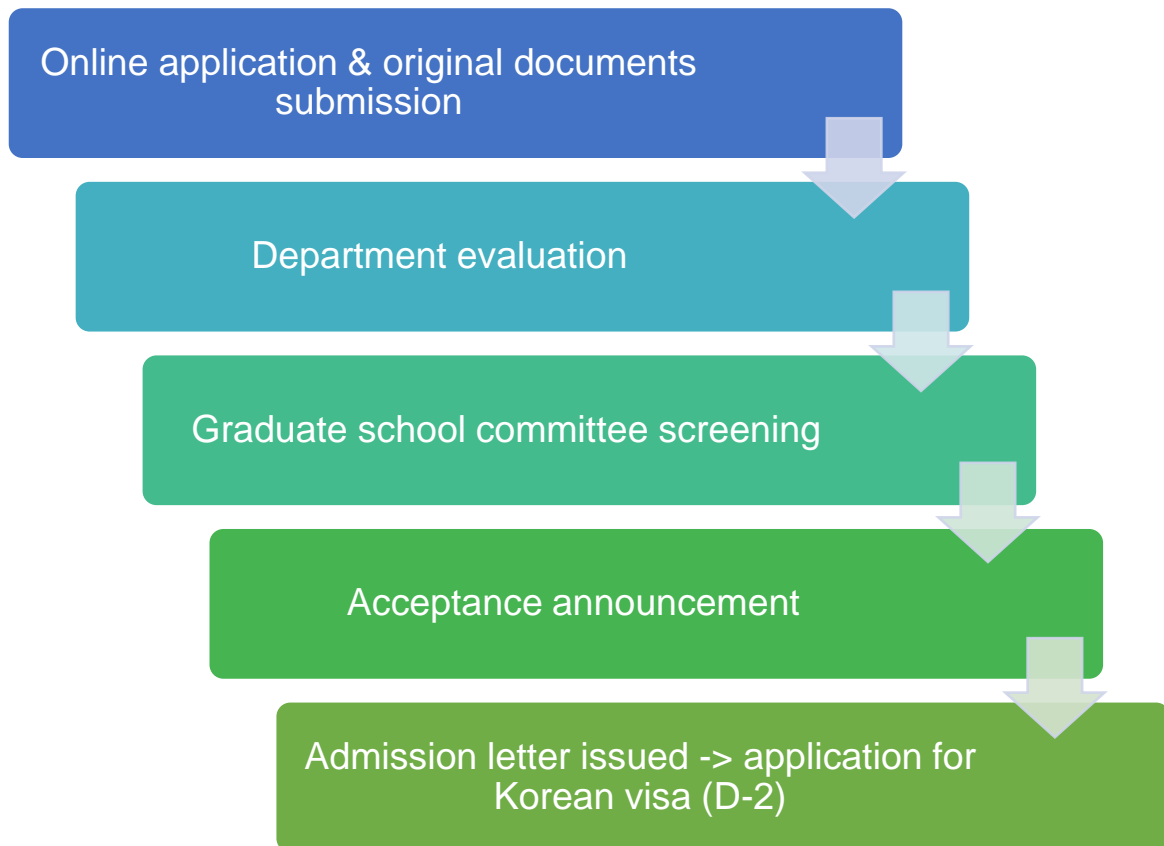
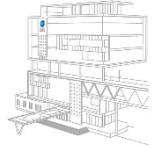

VISA PROCESS

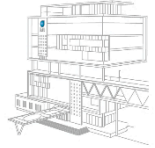

Every Graduate School international students must have a D-2 student visa.

Necessary documentation varies country to country.

Here is basic document to be prepared for getting D-2 visa.

The Korean Embassy in each country might ask you to submit additional documents.

Document (English)	Document (Korean)	Prepared by
Passport	여권	students
Photo	사진	Students
Visa issuance application	비자발급신청서	Students
Handling fee	수수료	Students
Documents proving the final level of education	최종학력증명서	Students
Documents proving your living expenses	재정능력입증서류	students
Standard certificate of admission	표준입학허가서	kit
Certificate of scholarship (if you are scholar)	장학생 증명서 (장학생일 경우)	kit
Certificate of business registration	사업자 등록증	kit
Certificate of affidavit of financial support (if you have any financial support)	재정보증인 재정보증확인서 (재정보증인이 있을 경우)	Supervisor professor Or other institute
Certificate of tuition payment	등록금 납부 확인서	kit

PROGRAMS FOR INTERNATIONAL STUDENTS

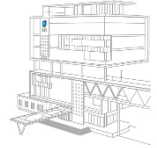

Free Korean language class

- We open free Korean language classes for all international students.
- Class will start with basic Korean alphabet (hangeul ㄱ, ㄴ, ㄷ, ㄹ).
- This is non-credit course.

Korean buddy program

- We will match one international student and one Korean student. These students will help you to settle yourself in Korea by helping to provide answers to basic questions you may have.

Voluntary Activity

- You can visit local elementary school, middle school or high school to introduce your own country.
- You will receive certificate for this voluntary activity and small amount of allowance as a reward.



Activities and field trip

- Every month, we offer various happy activity and field trip for international students

Cooking Day	Making Kimchi Event	Field Trip to Samsung	Chuseok Event
			
Winter Ski Camp	Halloween Day	Temple Stay	Nongshim Factory Tour
			

PART-TIME WORK



Part-time work for international students

- International students who hold D-2 Visa can have opportunity to do part-time work in Korea during one's study period.
- According to Korean immigration rules and regulations, all international students must report one's part-time work to local immigration office.
- Allowed working hours (as from 2018.10.)

Course	Grade	Korean language ability		When to start	Allowed hours		IEQAS (인증대학)
					During weekdays	During weekends & vacation	
Korean language program 한국어연수과정	n/a	TOPIK Level 2	X	Only start 6 months after arrival in Korea	10 hours	10 hours	10 hours
			O		20 hours	20 hours	25 hours
Undergraduates 학부	1, 2	TOPIK Level 3	X	No restriction	10 hours	10 hours	10 hours
			O		20 hours	Unlimited	25 hours
	3, 4	TOPIK Level 4	X	No restriction	10 hours	10 hours	10 hours
			O		20 hours	Unlimited	25 hours
Graduates (Master's/Ph.D.)	n/a	TOPIK Level 4	X	No restriction	15 hours	15 hours	15 hours
			O		30 hours	Unlimited	35 hours

- Allowed working places and categories: Translation, serving at restaurant or coffee shops, simple office work assistant (Any kind of teaching, teaching assistant or lecturing activity is strictly prohibited)
- Not allowed working places and categories
 - Any kind of teaching, teaching assistant, tutoring or lecturing activity is strictly prohibited
 - Working at manufacturing industry is strictly prohibited
 (*In case of manufacturing industry, you are eligible to work only if you have TOPIK level 4. According to 외국인 유학생 사증발급 및 체류관리 지침2019.03.04. 일부개정본)
 - Working at construction (building) industry is strictly prohibited
- Students who are not allowed to do part time job
 - Student whose attendance rate is less than 70%
 - Student whose average academic grade is less than C (2.0)

Rules regarding part-time work

•Final approval of your work will be made by the officer of immigration office.

If you violate part-time work regulation,

- Found your violation first time: you cannot do part time job for one year. Also, you will not be eligible to get D-10 visa for good.
- Found your violation second time: your study permit will be canceled for good, and will be deported immediately.
- In case you work at **construction (building) industry** illegally, there's no second chance. Once you get caught, you will be deported immediately. (one strike- out system)

If you have any question about immigration rule, please visit webpage below.

http://www.hikorea.go.kr/pt/main_en.pt